

Features

- Phosphor bronze, solder plated terminals
- Available in 1/8" and 1/4" shaft diameter
- Plastic flame retardant housing
- Available in audio taper (J types)



Spectrol No.	NTE Part No.	Value (Ohms)	Shaft Length	Diag No.
149-8-08-101	502-0002	100	3/4"	P7
149-9-10-101	502-0021	100	7/8"	P8
149-8-08-201	502-0003	200	3/4"	P7
149-9-10-201	502-0022	200	7/8"	P8
14910AABHSX10251KA	502-0004	250	3/4"	P7
14910FAGJSX10251KA	502-0023	250	7/8"	P8
14910AABHSX10501KA	502-0005	500	3/4"	P7
149-9-10-501	502-0024	500	7/8"	P8
14910AABHSX10102KA	502-0006	1K	3/4"	P7
14910FAGJSX10102KA	502-0025	1K	7/8"	P8
149-J-9-10-102	502-0045	1K	7/8"	P8
14910AABHSX10252KA	502-0007	2.5K	3/4"	P7
14910FAGJSX10252KA	502-0026	2.5K	7/8"	P8
14910AABHSX10502KA	502-0008	5K	3/4"	P7
14910FAGJSX10502KA	502-0027	5K	7/8"	P8
149-J-9-10-502	502-0047	5K	7/8"	P8
14910AABHSX10103KA	502-0009	10K	3/4"	P7
14910FAGJSX10103KA	502-0028	10K	7/8"	P8
149-J-9-10-103	502-0048	10K	7/8"	P8
14910AABHSX10253KA	502-0010	25K	3/4"	P7
14910FAGJSX10253KA	502-0029	25K	7/8"	P8
149-J-9-10-253	502-0049	25K	7/8"	P8
14910AABHSX10503KA	502-0011	50K	3/4"	P7
14910FAGJSX10503KA	502-0030	50K	7/8"	P8
149-J-9-10-503	502-0050	50K	7/8"	P8
14910AABHSX10104KA	502-0012	100K	3/4"	P7
14910FAGJSX10104KA	502-0031	100K	7/8"	P8
149-J-9-10-104	502-0051	100K	7/8"	P8
149-8-08-254	502-0013	250K	3/4"	P7
149-9-10-254	502-0032	250K	7/8"	P8
149-8-08-504	502-0014	500K	3/4"	P7
149-9-10-504	502-0033	500K	7/8"	P8
14910AABHSX10105KA	502-0015	1M	3/4"	P7
14910FAGJSX10105KA	502-0034	1M	7/8"	P8
149-8-08-205	502-0016	2M	3/4"	P7
149-9-10-205	502-0035	2M	7/8"	P8

Spectrol 149 Series

Potentiometer - 1 Watt, 1/2" square 1/8" and 1/4" dia. shaft

P7

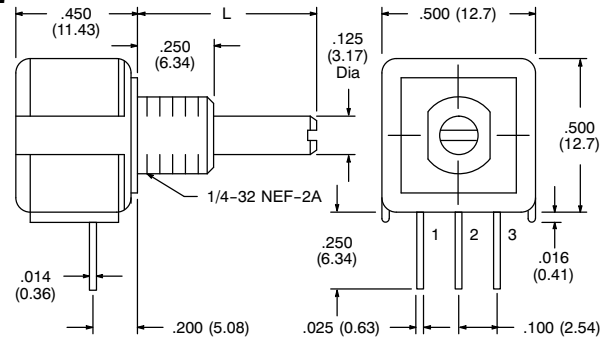

P8

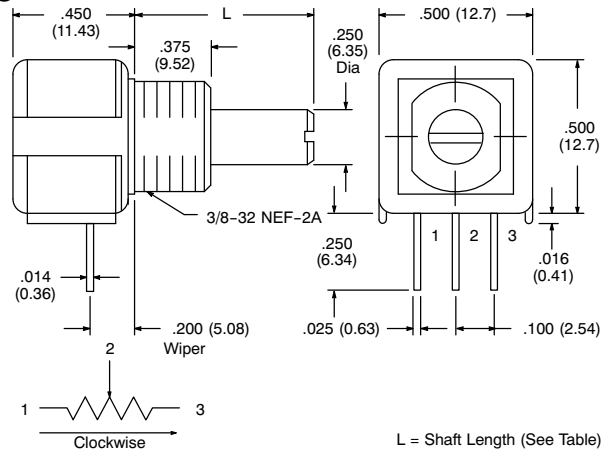

L = Shaft Length (See Table)

Specifications

Electrical

Resistance Range - Linear Taper: 100Ω to 2 Meg Ω
- CW Audio Taper: J types

Resistance Tolerance: ±10%

Power Rating: 1 Watt @ 70°C derated to 0 Watts @ 150°C

Temperature Coefficient of Resistance: ±150ppm/°C

Linearity Tolerance: ±5% independent

Contact Resistance Variation: 3% of total resistance

Insulation Resistance: 1000 Meg Ω min, 500VDC

Dielectric Strength: 750V RMS min 60Hz

End Resistance: 4Ω max each end

Effective Electrical Angle: 265° ±5°

Mechanical

Resistance Element: Cermet

Mechanical Rotation: 300° ±5°

Starting and Running Torque: 21.6 to 216gm-cm

End Stop Torque: 0.339Nm (48oz in)

Environmental

Operating Temperature: -40°C to +150°C

Storage Temperature: -55°C to +150°C

Rotation Life: 25,000 cycles

Load Life: 1000 hr.